



---

## Visit to Canterbury on Wednesday 24 February 2010

---

<b>Date:</b>	22 February 2010	<b>MfE Priority:</b>	Urgent
<b>Security Level:</b>		<b>Number of Attachments:</b>	4
		<b>MfE Ref No:</b>	10-B-00371

---

	<b>Description</b>	<b>Deadline</b>
Minister for the Environment Hon Dr Nick Smith	Information for Minister Smith and Hide's visit to Canterbury on 24 February 2010 to meet with ECan, Ngai Tahu and stakeholders to discuss the report 'Investigation of the Performance of Environment Canterbury under the Resource Management Act and Local Government Act'.	Meetings to be held in Christchurch from <b>8am Wednesday 24 February 2010.</b>

---

## Ministry for the Environment Contacts

---

---

<b>Name</b>	<b>Position</b>	<b>Telephone</b>		<b>1st Contact</b>
		<b>(cell)</b>	<b>(work)</b>	
Amy-Jane Millward	Senior Analyst, Monitoring, Compliance and Review	Withheld 9(2)(a)	04 439 7471	✓
Russell Burnard	Manager, Monitoring, Compliance and Review	021 822 257	04 439 7586	
Kevin Currie	Director, Environmental Protection	027 240 5643	04 439 7590	

## Purpose

---

The purpose of this Briefing is to provide background information for your visit to Christchurch on Wednesday 24 February. You are meeting with Environment Canterbury, Mayors and Chief Executives of Canterbury Territorial Authorities, stakeholders and Ngai Tahu to discuss the findings of the report *'Investigation of the Performance of Environment Canterbury under the Resource Management Act and Local Government Act'*.

## Who

---

You arrive in Christchurch at **7.30am on Wednesday 24 February 2010**. Together with Minister Hide you are hosting a series of meetings in meeting rooms 6 and 7, level 2 at the Christchurch Convention Centre (Kilmore Street). You will meet Ngai Tahu at their offices on Hereford Street at 12.30pm.

Time	Meeting with	Contact person	Comments
8.00am	Environment Canterbury	Alec Neill (Chair)	Alec indicated both Councillors and Senior Officers (Directors) will attend this session.
9.30am	Mayors and Chief Executives of territorial authorities	Bob Parker	This session will be well attended. Morning tea will be ready at 10am.
11.00am	Stakeholders	N/A	Attendees of this session mainly include those interviewed for the report.
12.30pm	Ngai Tahu	Michelle Long (EA to Mark Solomon)	Please note this meeting is at Ngai Tahu on Hereford street. You will need to leave CCC by 12.15pm.

The following detailed information is attached for your information:

- Appendix 1- run sheet for the visit;
- Appendix 2 - list of meeting attendees;
- Appendix 3 - floor plan of the Christchurch Convention Centre; and
- Appendix 4 – media clippings up to date as of 9am Tuesday 23 February 2010.

## Meeting logistics

---

All meetings (with the exception of the meeting with Ngai Tahu) will be held in Meeting rooms 6 and 7, level 2 of the Christchurch Convention Centre on Kilmore Street.

You will be met by ECan council, Chief Executive Officer and Directors when you arrive at 8am. It is expected that you will chair all meetings. It is advisable that each meeting finishes a few minutes before the next one to allow groups to come and go freely.

You will need to leave the Convention Centre by 12.15 to walk to Ngai Tahu. Ngai Tahu offices are at 158 Hereford Street (the same building as the Christchurch offices of Ministry for the Environment). Please ask for Aneke Goodall on arrival.

You will need to leave Ngai Tahu no later than 1.15pm to be on time for your return flight to Wellington.

## **Media interest**

---

As you are aware, there has been a substantial amount of media interest in the findings of the report. TV One News reported the location and day of these meetings accurately on Friday 19 February as part of their 6pm News bulletin. It is likely there will be news and television crews on site, both when you arrive and when departing.

Relevant media clippings (up to date as of 9am Tuesday 23 February) are attached in **Appendix 4**.

## **Key Points**

---

- You have four meetings in Christchurch on Wednesday 24 February 2010. The fourth meeting will be at Ngai Tahu on Hereford Street.
- You are expected to Chair all meetings.
- It is likely the media will be present when you arrive.

Russell Burnard  
**Manager, Monitoring, Compliance and Review**

**Date**

## Appendix 1 – Run sheet for visit to Christchurch

Time	Details	Contact person
7.30am	Arrive in Christchurch. Travel by taxi to meeting rooms 6 and 7 at Christchurch Convention Centre (Kilmore street).	Stacey Gavin
8.00am	Meeting 1 – Environment Canterbury. This meeting will be attended by Councillors and Senior Management from ECan (Chief Executive and Directors).	Alec Neill (Chair) 027 440 3731
9.20am	ECan meeting attendees depart. Break	
9.30am	Meeting 2 – Territorial Authorities. This meeting will be attended by Mayors and Chief Executives of all TA's in the Canterbury Region. Morning tea served (10am).	Bob Parker (Chair, Mayoral Forum) 027 443 4575
10.55am	Mayors and CE's depart. Break	
11.00am	Meeting 3 – Stakeholders. Primarily attended by CE's of companies interviewed for the report/their delegates.	N/A
12.15pm	Depart Convention Centre. Walk to Ngai Tahu (158 Hereford Street).	Aneke Goodall
12.30pm	Meeting 4 – Ngai Tahu. Meeting attended by ??	
1.15pm	Depart Ngai Tahu offices for Christchurch airport. Mark Solomon may accompany you.	

## Appendix 2 – List of probable meeting attendees

### Meeting 1 – 8.00am - Environment Canterbury

Name	Position
Alec Neill	Chair
Angus McKay	Councillor
Bob Kirk	Councillor
Bronwen Murray	Councillor
Carole Evans	Councillor
David Sutherland	Councillor
Eugenie Sage	Councillor
Jane Demeter	Councillor
Jo Kane	Councillor
Kerry Burke	Councillor
Mark Oldfield	Councillor
Pat Harrow	Councillor
Rik Tindall	Councillor
Ross Little	Councillor
Bryan Jenkins	Chief Executive
Jackie Curtis	Director, External relations
Don Rule	Director, Resource Planning and Consents
Ken Taylor	Director, Investigations and Monitoring
Wayne Thomas	Director, Finance and Corporate Services
Jill Atkinson	Director, Regional Programmes
Ken Lawn	Director, Operations
Kim Drummond	Director, Regulation

## Meeting 2 – 9.30am - Mayors and Chief Executives of Christchurch Territorial Authorities

Name	Position	Organisation
Bob Parker	Mayor	Christchurch City Council
Kevin Heays	Mayor	Kaikoura District Council
Garry Jackson	Mayor	Hurinui District Council
Bede O'Malley	Mayor	Ashburton District Council
Kevin Coe	Mayor	Selwyn District Council
Janie A	Mayor	Timaru District Council
Ron Keating	Mayor	Waimakiriri District Council
John Coles	Mayor	Waimate District Council
Alex Familton	Mayor	Waitaki District Council
John O'Neill	Mayor	MacKenzie District Council
Tony Maryatt	Chief Executive	Christchurch City Council
Stuart Grant	Chief Executive	Kaikoura District Council
Andrew Dalziel	Chief Executive	Hurinui District Council
Brian Lester	Chief Executive	Ashburton District Council
Paul Davey	Chief Executive	Selwyn District Council
Warwick Issacs	Chief Executive	Timaru District Council
Jim Palmer	Chief Executive	Waimakiriri District Council
Tony Alden	Chief Executive	Waimate District Council
Michael Ross	Chief Executive	Waitaki District Council
Glen Innes	Chief Executive	MacKenzie District Council

## Meeting 3 – 11am – Stakeholders

Name	Position	Organisation
Mike Britton	General Manager	Forest and Bird
Chris Todd	Delegate	Forest and Bird
Bryce Johnson	Chief Executive	Fish and Game
Ross Millichamp	Delegate	Fish and Game
Tony Hawker	Delegate	Fish and Game
Polly Miller	Interviewee	White Water New Zealand
Lauren Semple	Chief Executive	Anderson Lloyd
Dr Brent Cowie	Individual	Brent Cowie
Kevin Jaffe	Interviewee	Simpson Grierson
Peter Callander	Director	Pattle Delamore Partners
Allan Watson	Delegate	Central Plains Water
Peter Lowe (+2)	Interviewee	Ashburton – Valletta Groundwater Applicants
Chris Pickrill Tony Sewell	Board members	Canterbury Chamber of Commerce
Don Nicolson	President	Federated Farmers
Liz Weir	Interviewee	Malvern Hills Protection Society
Andrew Curtis	Chief Executive	Irrigation New Zealand
Robert Johnston	Individual	N/A
Mike Reid	Manager	Local Government New Zealand

Hugh Canard	Land and Water Forum	Whitewater New Zealand
Peter Weir	Land and Water Forum	NZ Forest Owners Association
Hamish Cuthbert Sean McCready	Land and Water Forum	Meredian Energy

#### **Meeting 4 – 12.30pm – Ngai Tahu**

<b>Name</b>	<b>Position</b>	<b>Organisation</b>
Mark Solomon	Kaiwhakahaere	Te Rūnanga o Ngāi Tahu
Anake Goodall	Chief Executive Officer	Te Rūnanga o Ngāi Tahu
Maree Willetts	Manager, Toitu te Whenua	Te Rūnanga o Ngāi Tahu

# Appendix 3 – Map of Christchurch Convention Centre

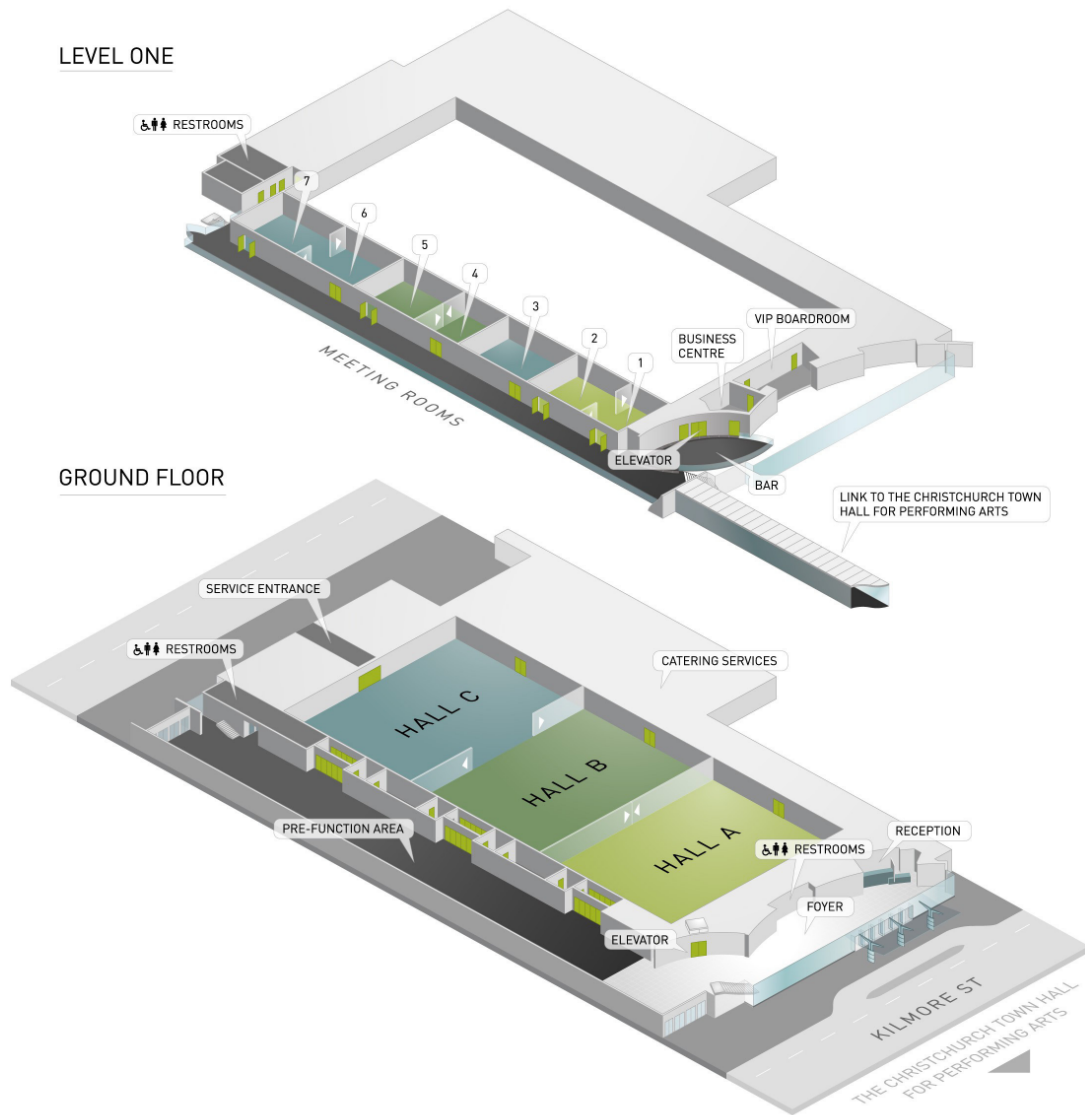

**Appendix 4 – Media clippings (current to 9am Tuesday 23 February 2010)**